

Small roll feed with integrated control system

## COMPACT EV DR IC

Models: EV DR 040 IC | EV DR 080 IC | EV DR 160 IC | EV DR 240 IC

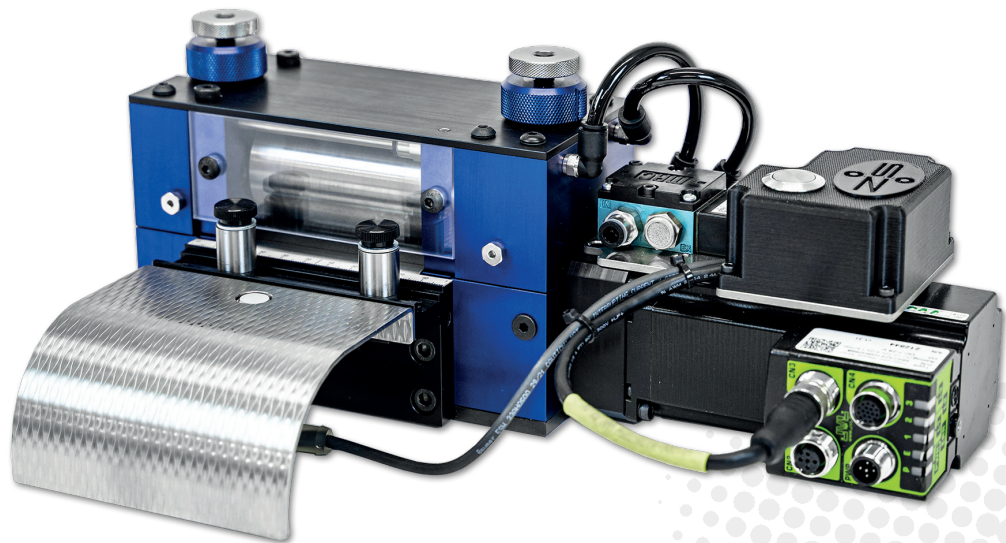

### COMPACT. PROVEN. ECONOMICAL.

- Motor with precision encoder and integrated control unit
- Very compact dimensions (installation also in tools)
- Proven mechanics, directly driven lower roll
- Optional: steel rolls, rubber coated rolls, segment rolls
- Low-cost, low-maintenance complete system
- Quick replacement of feed and control system

### IMPROVED EASE OF OPERATION (IN COMPARISON WITH EVD DG)

- Quickly replaceable rolls
- Easily removable infeed for cleaning the rolls
- Improved adjustment of pilot release
- Adjustable roll baskets, inlet plates, mounting plate
- Compatible with mounting plate
- Optional material guides, mass scale

### POLYVALENT IC CONTROL

- Integrated control with safety STO
- Optional IC Connect Box with touch control panel
- Bus connections (EtherCAT; Profinet)
- Signal box with treading aid

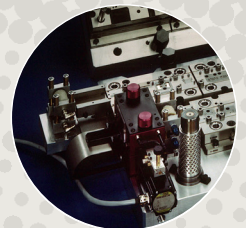

ZEHNDER  
SOMMER

SWISS  
PRECISION  
FEEDING

# COMPACT ROLL FEED EV DR IC



PERFORMANCE

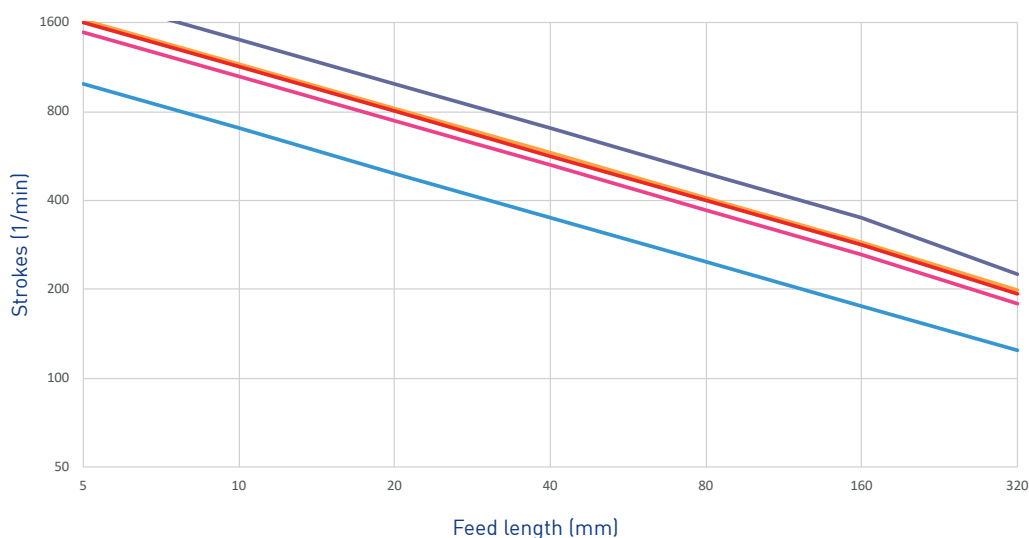

Performance curves  
(Examples)\*

| Loop weight / Feed angle |
|--------------------------|
| 0 kg / 180°              |
| 0.5 kg / 180°            |
| 2 kg / 180°              |
| 2 kg / 240°              |
| 2 kg / 120°              |

\*Calculation basis: EV DR 080 IC  
Power in: 48V

TECHNICAL SPECIFICATIONS

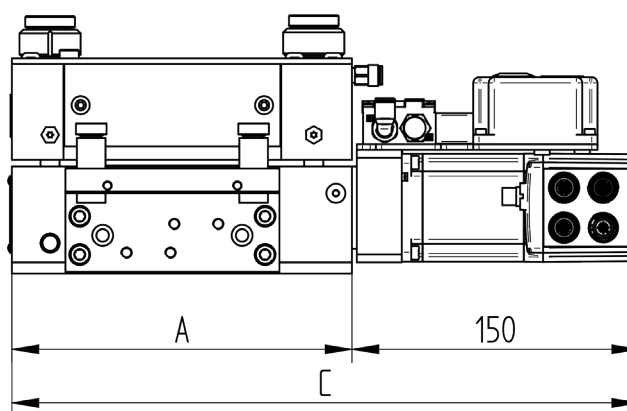
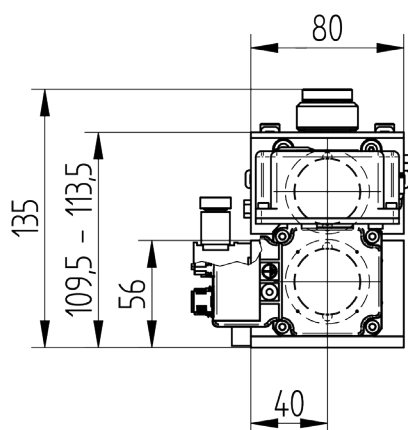

| MODEL                       | EV DR IC | 040                     | 080 | 160 | 240 |
|-----------------------------|----------|-------------------------|-----|-----|-----|
| Support width A (mm)        |          | 138                     | 178 | 258 | 338 |
| Overall width C (mm)        |          | 288                     | 328 | 408 | 488 |
| Band thickness              |          | max. 4 mm               |     |     |     |
| Roll diameter               |          | 44 mm                   |     |     |     |
| Accuracy                    |          | +/- 0.06 mm             |     |     |     |
| Traction max.*              |          | 60 N                    |     |     |     |
| Cross section (recommended) |          | max. 50 mm <sup>2</sup> |     |     |     |

## SWITZERLAND

Zehnder & Sommer AG  
CH-3400 Burgdorf  
info@zehndersommer.com  
Tel +41 31 800 00 00

## GERMANY

Zehnder & Sommer GmbH  
DE-58452 Witten  
info@zehndersommer.de  
Tel +49 2302 981 60 30

zehndersommer.com  
ZSswiss.com

\*Depending on motor, control and supply.  
Ask for a specific configuration and calculation.